

MBR-SK with normal expansion and head hole MN5 / M5

Nylon Products

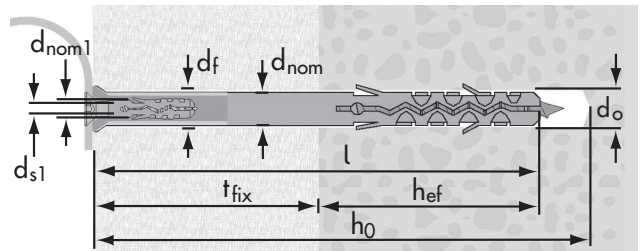
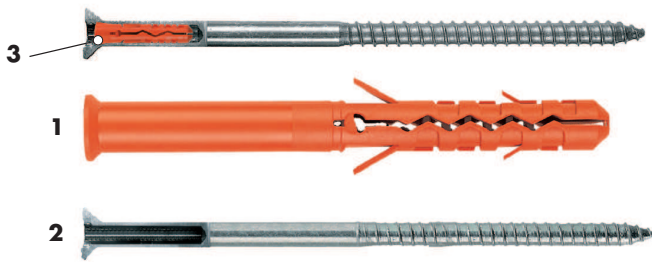

Name

- 1 Nylon plug MBR
- 2 Screw with head hole M5 / T40
- 3 MN Plug

Features

Through fixing

Building materials

Qualities



Characteristics

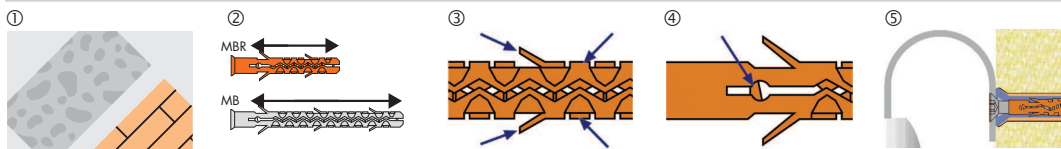

- ① Recommended and suitable for applications in solid materials
- ② MBR with normal expansion zone for applications in concrete and solid brick
- ③ Wings - Stop the plug rotating in the drill hole
- ④ Knock-in protection - Prevents premature expansion while installing
- ⑤ Bridging of non-bearing wall materials: the application of the building materials occurs exclusively on the bolt head

Applications

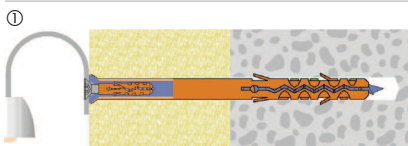

- ① Ideal fastening of items as lamps, roller blinds, rails etc. on thick insulations

Installation

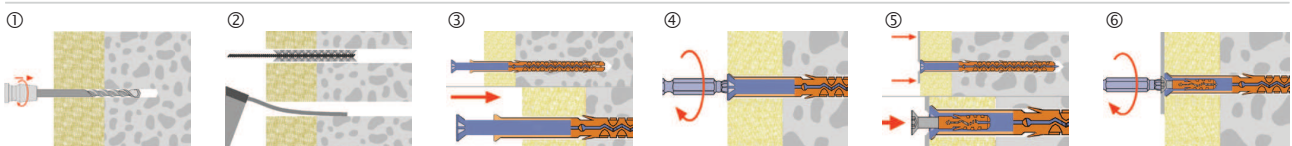

- ① Position the fixture and make the drill hole
- ② Clean the drill hole
- ③ Insert the screw into the plug
- ④ Tighten the screw with the blank head hole
- ⑤ Insert the screw with the plug into the head hole
- ⑥ Tighten the building materials with the screw in the bolt head

MBR-SK with plug

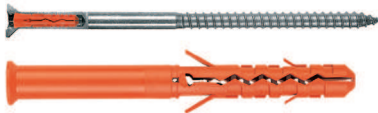
	Plug size		10						
N _{Rec}	- Concrete	kN	0.8						
	- Solid brick		0.6						
	- Sandstone		0.6						
h _{ef}	Effective anchorage depth	mm	50						
d _{s1}	Screw-Ø	mm	4						
h ₀	Drill hole depth	mm	60						
d ₀	Drill hole in the building material	mm	10						
d _f	Clearance hole in fixture	mm	10						
l	Plug length	mm	80	100	120	140	160	200	240
d _{nom}	Outside-Ø plug	mm	10						
d _{nom1}	Plug-Ø head hole	mm	5						
t _{fix}	Assembling usable length	mm	30	50	70	90	110	150	190
			1121208	1121210	1121220	1121240	1121260	1121290	1121294

MBR-SK with plug MN5

Safety factor 5

SR-SK

	Screw size		7				
N _{Rec}	- Concrete	kN	0.8				
	- Solid brick		0.6				
	- Sandstone		0.6				
d _s	Screw-Ø	mm	M5				
l _s	Screw length	mm	105	125	145	165	205
l _G	Internal thread length	mm	18				
d	Internal thread-Ø	M	5				
			62916260	62916300	62916340	62916380	62916460

SR-SK Screw with internal thread M5/T40